

MANUAL 2-WAY VACUUM VALVES

These manual valves are used for intercepting vacuum in all those plants where solenoid valves cannot be installed.

They feature a die-cast nickel-plated brass body, a chromed brass ball shutter and teflon seals to guarantee perfect seal even at high temperatures.

A lever on the ball shutter, rotated by 90°, allows opening or closing the valve with no effort.

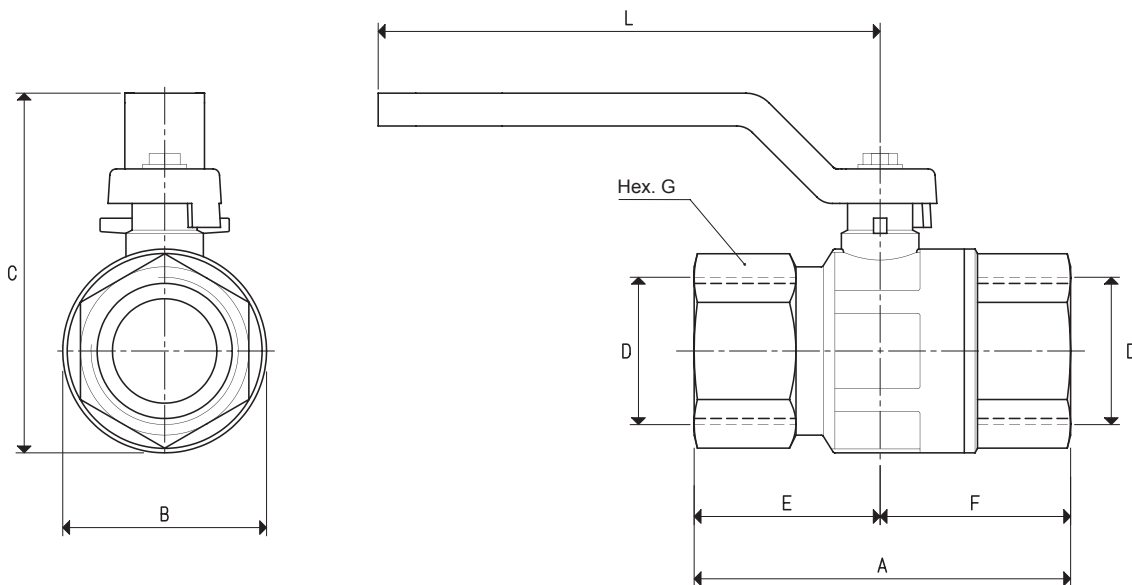

3D drawings available at www.vuototecnica.net

MANUAL 2-WAY VALVES

Art.	A	B	C	D Ø	E	F	G	L	Weight Kg
13 01 10	49	23	48	G1/4"	24	25	18	80	0.13
13 02 10	52	23	56	G3/8"	23	29	20	80	0.13
13 03 10	61	30	63	G1/2"	30	31	25	88	0.21
13 04 10	68	36	72	G3/4"	33	35	31	114	0.32
13 05 10	85	44	80	G1"	42	43	38	113	0.47
13 06 10	99	57	105	G1" 1/4	50	49	47	137	0.74
13 07 10	109	70	126	G1" 1/2	55	54	54	156	1.26
13 08 10	130	83	135	G2"	62	68	66	156	1.77
13 09 10	168	140	210	G3"	84	84	99	246	7.09