

## CUPS WITH VULCANISED SUPPORT

These sturdy and rather deep cups are designed to handle bodywork components in moulded sheet steel.

These cups are produced with a special compound called BENZ, which can resist to heavy loads and to the chlorine usually contained in the oil used for moulding and drawing of the sheet steel.

The galvanised steel support is vulcanised onto the cup. Galvanised steel adapters are also available to allow modifying the suction connection from M10 to gas or NPT threads.

Cups in special compounds indicated at page 21 can be provided upon request in minimum quantities to be defined in the order.

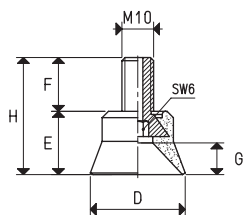

CUPS WITH VULCANISED SUPPORT

Art.	Force Kg	D Ø	E	F	G	H	Support material	Weight g
08 30 38 *	1.80	30	20	17	10	37	steel	20.8
08 40 41 *	3.20	40	23	18	12	41	steel	24.9

\* Complete the code indicating the compound: B= BENZ rubber; N= natural para rubber; S= silicon

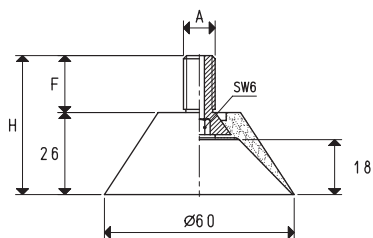

CUPS WITH VULCANISED SUPPORT

Art.	Force Kg	A Ø	F	H	Support material	Weight g
08 60 45 *	7.10	M10	18	44	steel	29.5
08 60 45 1/4" *	7.10	G1/4"	10	36	steel	34.4

\* Complete the code indicating the compound: B= BENZ rubber; N= natural para rubber; S= silicon

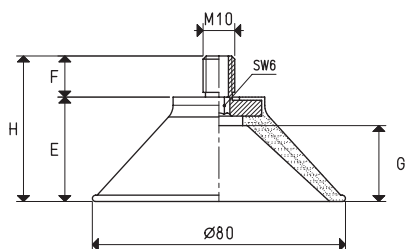

CUPS WITH VULCANISED SUPPORT

Art.	Force Kg	E	F	G	H	Support material	Weight g
08 80 50 *	12.60	33	18	26	51	steel	58.0

\* Complete the code indicating the compound: B= BENZ rubber; N= natural para rubber; S= silicon

REDUCTIONS

Art.	D Ø	d Ø	H	Reduction material	Weight g
00 08 130 *	G1/4"	M10	14	steel	4.9
00 08 131 *	G3/8"	M10	14	steel	12.8
00 08 254 *	1/4" NPT	M10	14	steel	4.8
00 08 255 *	3/8" NPT	M10	14	steel	12.7

